

A	15,58 x 11,40	=	177,61 mq
B	10,38 x 2,10	=	21,80 mq
C	0,23 x 1,75	=	0,40 mq
D	6,06 x 9,96	=	60,36 mq
E	3,46 x 2,52	=	8,72 mq
F	1,80 x 0,28	=	0,50 mq
G	(11,81 x 7,28) : 2	=	42,99 mq
H	(6,93 x 2,06) : 2	=	7,15 mq
I	(6,93 x 2,06) : 2	=	7,15 mq
J	10,1 x 1,68	=	16,97 mq
K	((10,75 + 10,10) x 3,52) : 2	=	36,70 mq
L	11,7 x 4,47	=	52,30 mq
M	11,43 x 4,51	=	51,55 mq
N	6,03 x 6,41	=	38,65 mq
O	9,95 x 5,94	=	59,10 mq
P	9,04 x 1,77	=	16,00 mq
Q	12,08 x 6,39	=	77,19 mq
R	13,17 x 14,8	=	194,91 mq
S	7,77 x 5,35	=	41,57 mq
T	2,71 x 2,32	=	6,29 mq
U	2,71 x 2,32	=	6,29 mq
V	PARTI CURVE	=	5,09 mq
W	6,03 x 6,41	=	38,65 mq
X	9,95 x 5,94	=	59,10 mq
Y	9,04 x 1,77	=	16,00 mq
Z	12,08 x 6,39	=	77,19 mq
<b>SLP Piano Interrato = 938 mq</b>			

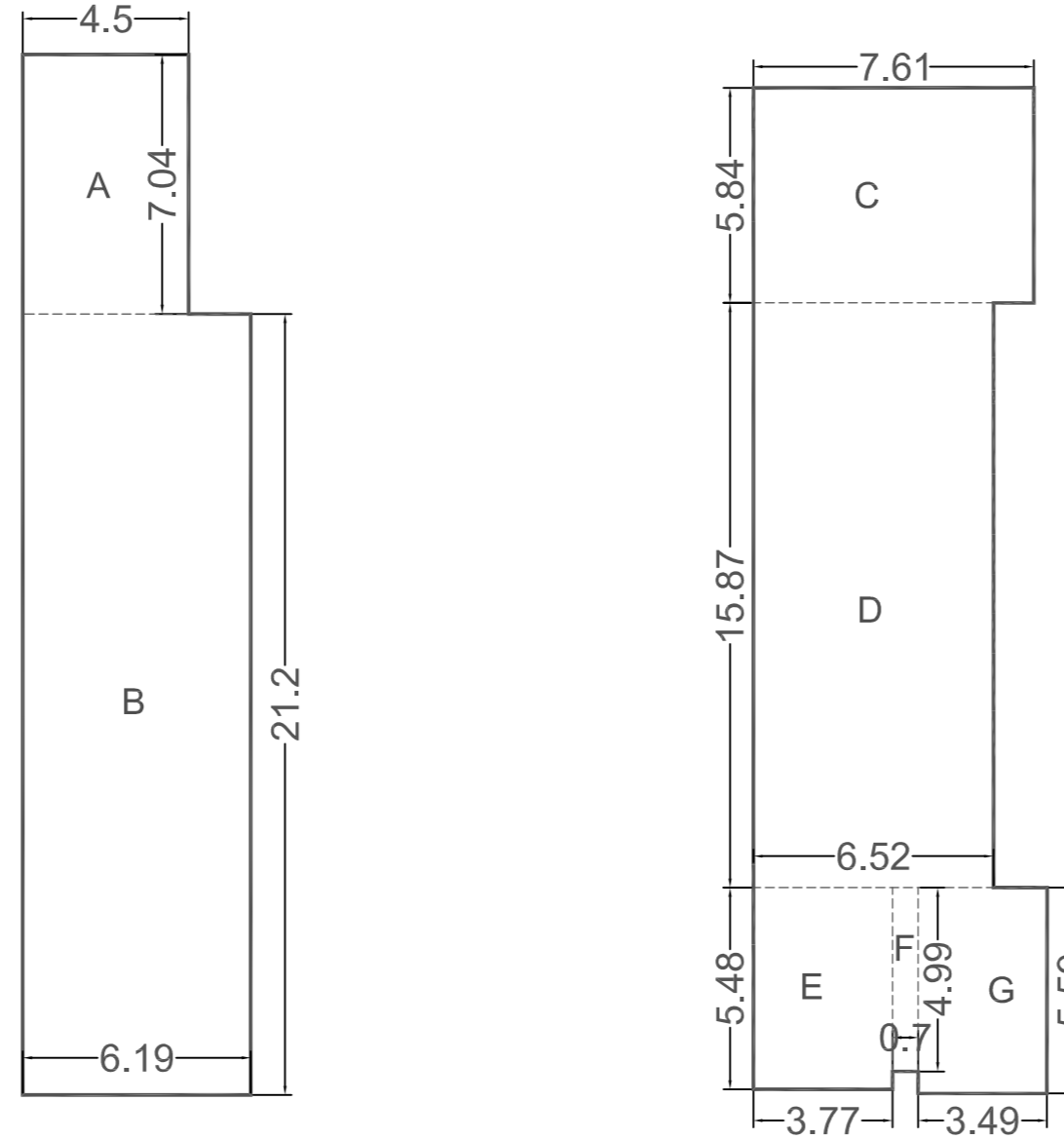

A	4,50 x 7,04	=	31,68 mq
B	21,20 x 6,19	=	131,22 mq
C	7,61 x 5,84	=	44,44 mq
D	6,52 x 15,87	=	103,47 mq
E	5,48 x 3,77	=	20,66 mq
F	0,70 x 4,99	=	3,49 mq
G	3,49 x 5,59	=	19,51 mq
H	4,70 x 3,99	=	18,75 mq
I	3,32 x 5,41	=	17,96 mq
<b>SLP Piano Terra = 392 mq</b>			

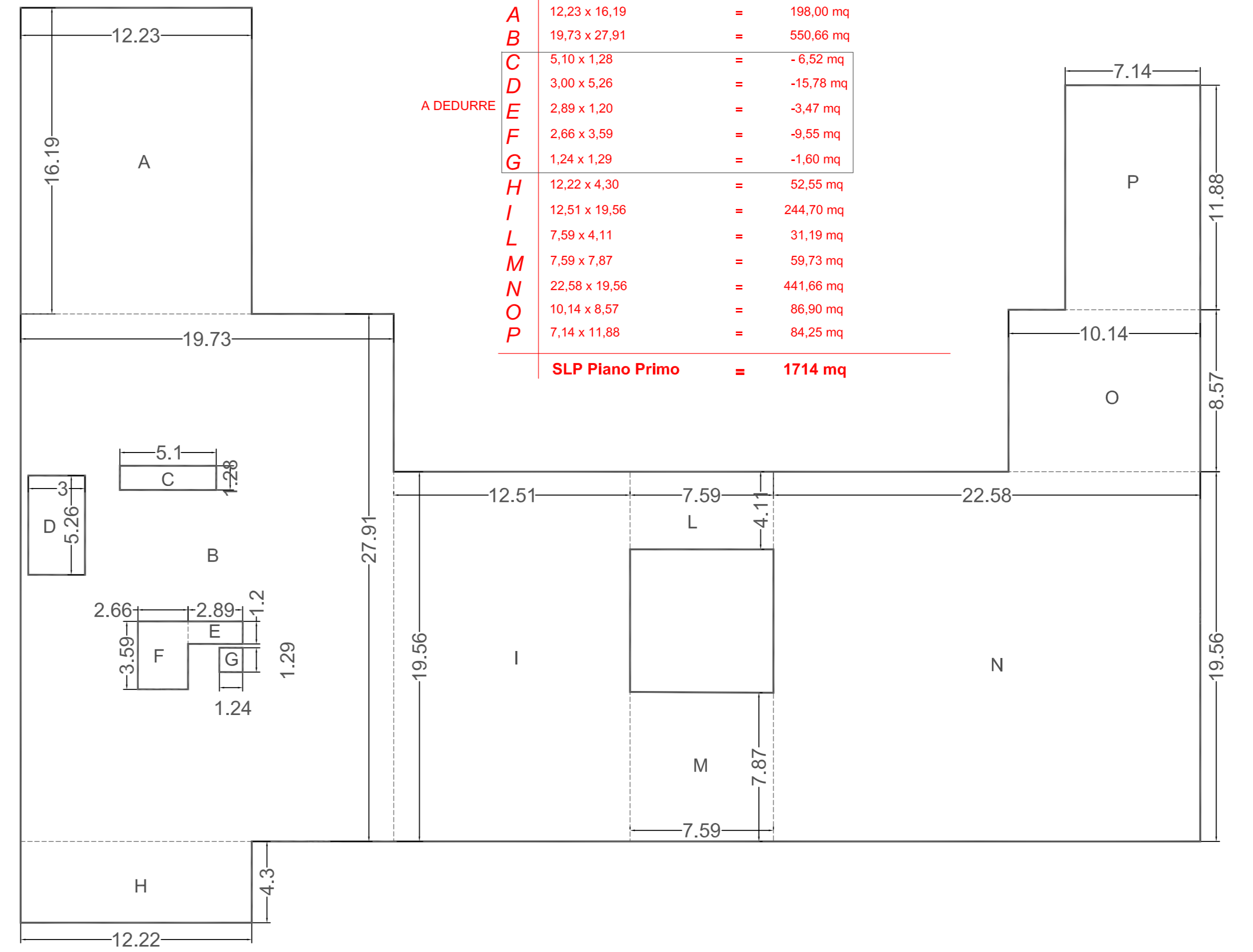

A	12,23 x 16,19	=	198,00 mq
B	19,73 x 27,91	=	550,66 mq
C	5,10 x 1,28	=	-6,52 mq
D	3,00 x 5,26	=	-15,78 mq
E	2,89 x 1,20	=	-3,47 mq
F	2,66 x 3,59	=	-9,55 mq
G	1,24 x 1,29	=	-1,60 mq
H	12,22 x 4,30	=	52,55 mq
I	12,51 x 19,56	=	244,70 mq
J	7,59 x 4,11	=	31,19 mq
K	7,59 x 7,87	=	59,73 mq
L	22,58 x 19,56	=	441,66 mq
M	10,14 x 8,57	=	86,90 mq
N	7,14 x 11,88	=	84,25 mq
O	10,14 x 8,57	=	86,90 mq
P	7,14 x 11,88	=	84,25 mq
<b>SLP Piano Primo = 1714 mq</b>			

COMUNE DI SOLBIATE OLONA  
**PERMESSO DI COSTRUIRE**  
IN VARIANTE ALLO STRUMENTO URBANISTICO VIGENTE  
NUOVO CAMPO PRATICA - AMPLIAMENTO CLUB HOUSE E  
STRUTTURE DEL GOLF CLUB LE ROBINIE

ELABORATO	PC 32.2	REVISIONE	
TITOLO	VERIFICHE PROGETTO Dimostrazione SLP CLUB HOUSE	SCALA	1 : 200
PROPRIETA'	VILLA OLONA S.p.a.		
PROGETTISTA	ING. EMILIO CREMONA		
DATA	09.2016	FILE	
REVISIONE 01		FILE	
REVISIONE 02		FILE	